

Auditorium – a traditional theater located on the first floor of the Port Administration Building with comfortable, graduated seating and a roomy stage

Style:	Presentation / Seminar
Dimensions:	2,600 S.F.
Max Capacity:	207 theater
Availability:	8 a.m. – 5 p.m., M-F
Fee Includes:	Use of the space, available seating, audio visual system and first floor restrooms; room and seating cannot be reconfigured; no food or beverage is allowed in the Auditorium (with the exception of bottled water for the speakers)

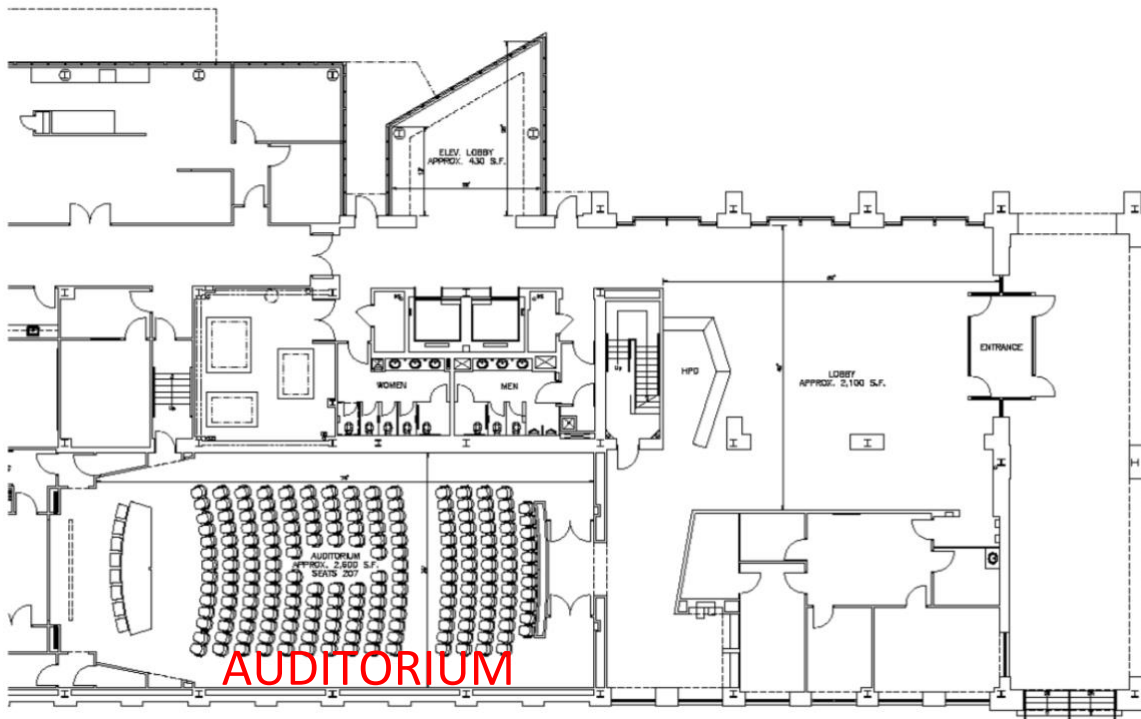

Port Administration Building – Parking Options:

Evenings and Weekends, **NOT** available for rental during regular business hours (8 a.m. – 5 p.m., M-F)

Employee Parking Lot

Style:	Parking
Max Capacity:	100 cars (94 regular spaces; 6 handicapped spaces)
Fee Includes:	Use of all spaces; if the lot needs to be reconfigured in any manner for the event’s use, additional charges will apply

Visitors Parking Lot

Style:	Parking
Max Capacity:	38 cars (36 regular spaces; 2 handicapped spaces)
Fee Includes:	Use of the Visitors Parking Lot is included in the fees for all other Port Administration Building spaces rented for non-business hour events